

- NOTES**
1. ALL DIMENSIONS IN METRES UNLESS STATED OTHERWISE.
  2. DO NOT SCALE FROM THIS DRAWING. USE ONLY PRINTED DIMENSIONS.
  3. ALL EASEMENTS, SERVITUDES AND PRIVATE RIGHTS ARE PROPOSED TO BE EXTINGUISHED ON LAND THAT IS TO BE ACQUIRED UNLESS STATED OTHERWISE IN THE BOOK OF REFERENCE.
  4. THIS DRAWING IS TO BE READ IN CONJUNCTION WITH ALL OTHER PLANS AND DOCUMENTATION. IN PARTICULAR THE WORK PLANS AND THE BOOK OF REFERENCE.

- LEGEND**
- LIMITS OF LAND TO BE ACQUIRED OR USED PERMANENTLY OR TEMPORARILY (THE ORDER LIMITS)
  - AREA NOT INCLUDED WITHIN THE ORDER LIMITS

First Issue	SM	CH	16/04/19	C01
Revision Details	By	Check	Date	Suffix

Purpose of issue  
**DCO APPLICATION**

Client  
**Highways England**  
Two Colmore Square  
30 Colmore Circus  
Birmingham  
B4 6BN



Development Consent Order Number  
**TR010022**

Project Title  
**A38  
DERBY JUNCTIONS**

Drawing Title  
**SPECIAL CATEGORY  
LAND PLANS  
REGULATION 5(2)(i)  
KEY PLAN**

Designed SM	Drawn LD	Checked CH	Approved SM	Date 16/04/19
Internal Project No. 60533462		Suitability D7		
Scale @ A1 NTS		Zone Whole Scheme		

THIS DOCUMENT HAS BEEN PREPARED PURSUANT TO AND SUBJECT TO THE TERMS OF AECOM'S APPOINTMENT BY ITS CLIENT. AECOM ACCEPTS NO LIABILITY FOR ANY USE OF THIS DOCUMENT OTHER THAN BY ITS ORIGINAL CLIENT OR FOLLOWING AECOM'S EXPRESS AGREEMENT TO SUCH USE, AND ONLY FOR THE PURPOSES FOR WHICH IT WAS PREPARED AND PROVIDED

Drawing Number HE514503	Originator -ACM	Volume -DCO	Rev C01
Location A38_SW_PR_ZZ		Type / Role / Number -DR-DC-9700	

Plot Date: 16 April 2019 16:46:47  
File Name: G:\CAD\_IT\GIS COMMISSION DIRECTORY\A38 Derby - 302014 - Special Category Land Plans\HE514503-ACM-DCO-A38\_SW\_PR\_ZZ-DR-DC-9700.mxd

This map is based upon Ordnance Survey material with the permission of Ordnance Survey on behalf of the Controller of Her Majesty's Stationary Office © Crown copyright. Unauthorised reproduction infringes Crown copyright and may lead to prosecution or civil proceedings. Highways England 100030649 2019.

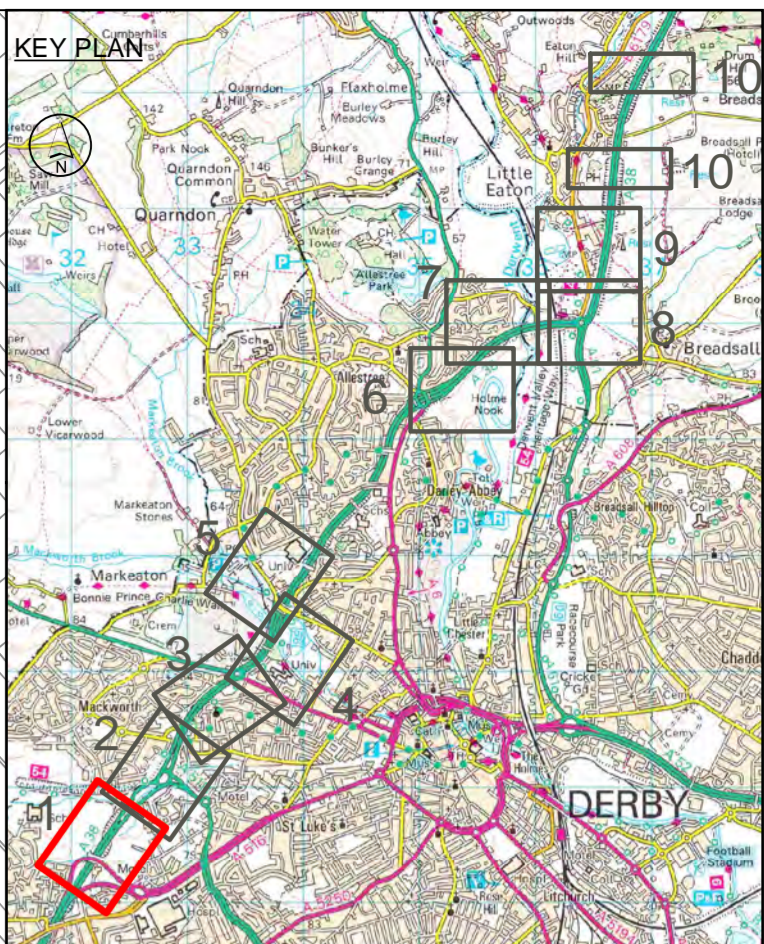
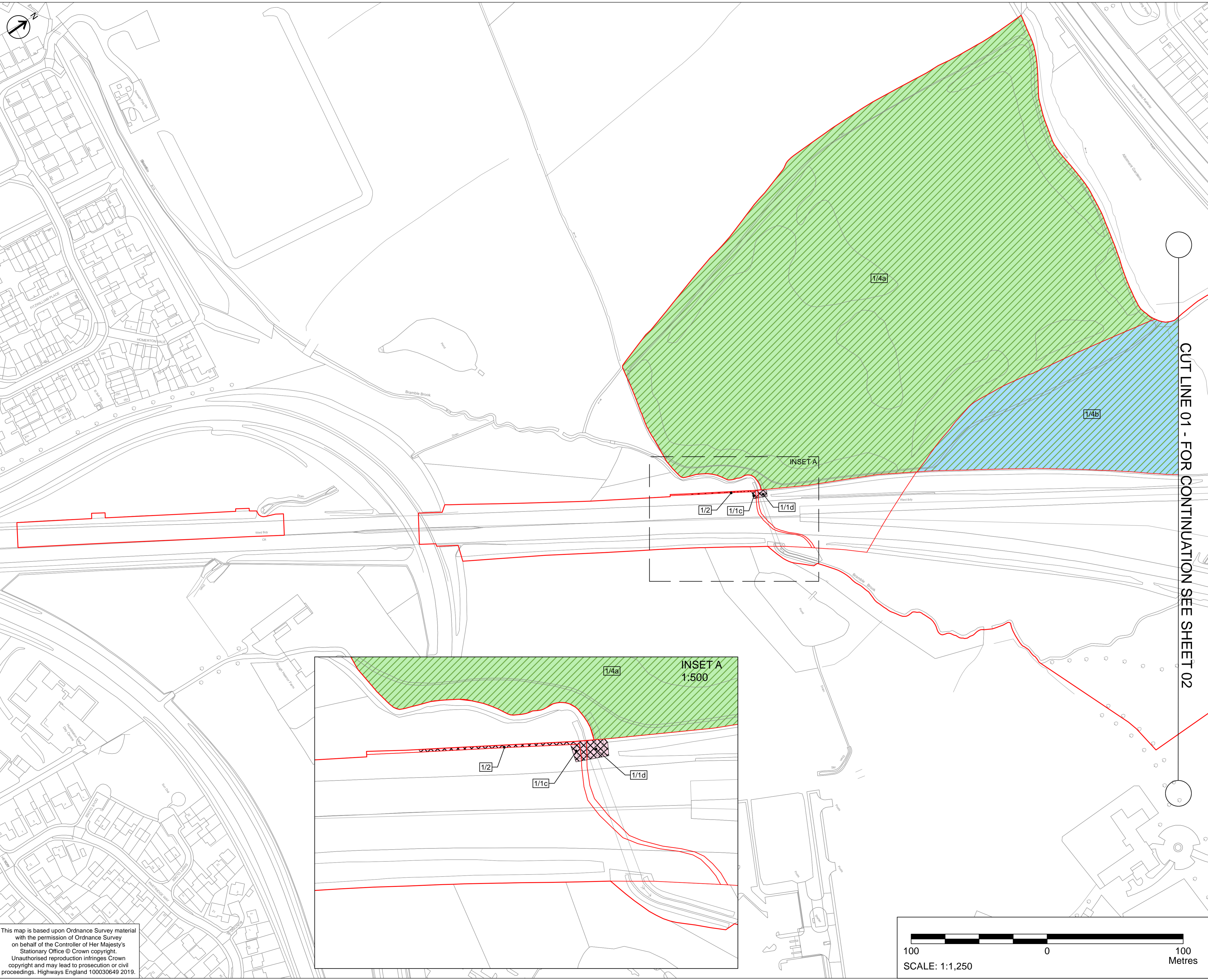

- NOTES**
1. ALL DIMENSIONS IN METRES UNLESS STATED OTHERWISE.
  2. DO NOT SCALE FROM THIS DRAWING, USE PRINTED DIMENSIONS.
  3. ALL EASEMENTS, SERVITUDES AND PRIVATE RIGHTS ARE PROPOSED TO BE EXTINGUISHED ON LAND THAT IS TO BE ACQUIRED UNLESS STATED OTHERWISE IN THE BOOK OF REFERENCE.
  4. THIS DRAWING IS TO BE READ IN CONJUNCTION WITH ALL OTHER PLANS AND DOCUMENTATION, IN PARTICULAR THE WORK PLANS AND THE BOOK OF REFERENCE.

- LEGEND**
- LIMITS OF LAND TO BE ACQUIRED OR USED PERMANENTLY OR TEMPORARILY (THE ORDER LIMITS)
  - 123 PLOT REFERENCE NUMBER (REFER TO BOOK OF REFERENCE FOR FURTHER INFORMATION)
  - LAND NOT INCLUDED WITHIN THE ORDER LIMITS
  - SPECIAL CATEGORY LAND - OPEN SPACE - LAND TO BE ACQUIRED PERMANENTLY
  - SPECIAL CATEGORY LAND - OPEN SPACE - LAND TO BE ACQUIRED PERMANENTLY AND RETAINED FOR USE AS OPEN SPACE
  - SPECIAL CATEGORY LAND - OPEN SPACE - LAND TO BE USED TEMPORARILY AND RIGHTS TO BE ACQUIRED PERMANENTLY
  - SPECIAL CATEGORY LAND - OPEN SPACE - LAND TO BE USED TEMPORARILY
  - SPECIAL CATEGORY LAND - REPLACEMENT LAND
  - FULL DCO PLOT EXTENT

Revision Details	By	Check	Date	Suffix
Post Acceptance Amendments	SM	JB	17/06/19	C02
First Issue	SM	CH	16/04/19	C01

**DCO APPLICATION**

Client: **Highways England**  
 Floor 5  
 Two Colmore Square  
 30 Colmore Circus  
 Birmingham  
 B4 6BN



Development Consent Order Number: **TR010022**

Project Title: **A38 DERBY JUNCTIONS**

Drawing Title: **SPECIAL CATEGORY LAND PLANS REGULATION 5(2)(i) SHEET 1 OF 10**

Designed	Drawn	Checked	Approved	Date
SM	LD	CH	SM	17/06/19

Internal Project No. 60533462  
 Suitability D7  
 Scale @ A1 1:1250  
 Zone Whole Scheme

THIS DOCUMENT HAS BEEN PREPARED PURSUANT TO AND SUBJECT TO THE TERMS OF AECOM'S APPOINTMENT BY ITS CLIENT. AECOM ACCEPTS NO LIABILITY FOR ANY USE OF THIS DOCUMENT OTHER THAN BY ITS ORIGINAL CLIENT OR FOLLOWING AECOM'S EXPRESS AGREEMENT TO SUCH USE, AND ONLY FOR THE PURPOSES FOR WHICH IT WAS PREPARED AND PROVIDED.

Drawing Number	Originator	Volume	Rev
HE514503 -ACM -DCO			C02
A38_SW_PR_ZZ -DR-DC-9701			
Location	Type	Role	Number

CUT LINE 01 - FOR CONTINUATION SEE SHEET 02

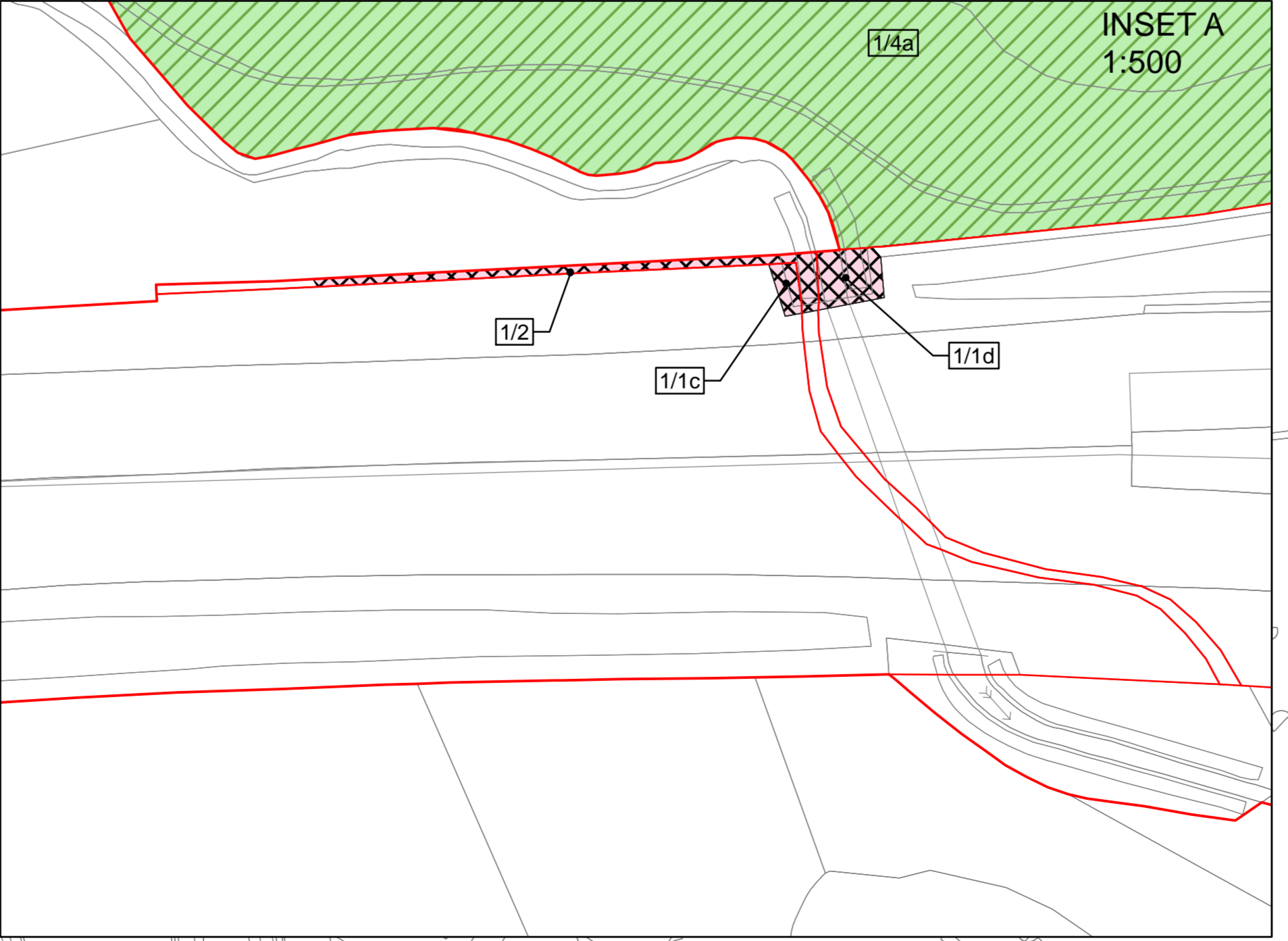

This map is based upon Ordnance Survey material with the permission of Ordnance Survey on behalf of the Controller of Her Majesty's Stationary Office © Crown copyright. Unauthorised reproduction infringes Crown copyright and may lead to prosecution or civil proceedings. Highways England 100030649 2019.

Plot Date: 17 June 2019 14:41:33  
 File Name: G:\CAD\_IT\GIS COMMISSION DIRECTOR\A38 Derby - 302014 - Special Category Land Plans\HE514503-ACM-DCO-A38\_SW\_PR\_ZZ-DR-DC-9701.mxd

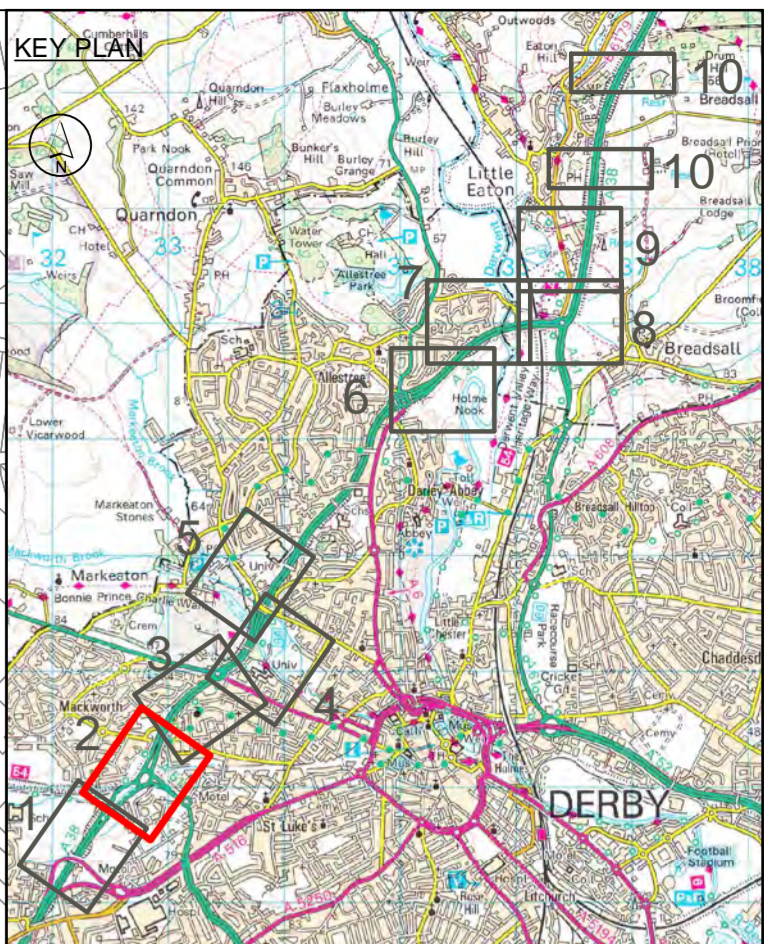

- NOTES**
1. ALL DIMENSIONS IN METRES UNLESS STATED OTHERWISE.
  2. DO NOT SCALE FROM THIS DRAWING, USE ONLY PRINTED DIMENSIONS.
  3. ALL EASEMENTS, SERVITUDES AND PRIVATE RIGHTS ARE PROPOSED TO BE EXTINGUISHED ON LAND THAT IS TO BE ACQUIRED UNLESS STATED OTHERWISE IN THE BOOK OF REFERENCE.
  4. THIS DRAWING IS TO BE READ IN CONJUNCTION WITH ALL OTHER PLANS AND DOCUMENTATION, IN PARTICULAR THE WORK PLANS AND THE BOOK OF REFERENCE.

- LEGEND**
- LIMITS OF LAND TO BE ACQUIRED OR USED PERMANENTLY OR TEMPORARILY (THE ORDER LIMITS)
  - 123 PLOT REFERENCE NUMBER (REFER TO BOOK OF REFERENCE FOR FURTHER INFORMATION)
  - LAND NOT INCLUDED WITHIN THE ORDER LIMITS
  - SPECIAL CATEGORY LAND - OPEN SPACE - LAND TO BE ACQUIRED PERMANENTLY
  - SPECIAL CATEGORY LAND - OPEN SPACE - LAND TO BE ACQUIRED PERMANENTLY AND RETAINED FOR USE AS OPEN SPACE
  - SPECIAL CATEGORY LAND - OPEN SPACE - LAND TO BE USED TEMPORARILY AND RIGHTS TO BE ACQUIRED PERMANENTLY
  - SPECIAL CATEGORY LAND - OPEN SPACE - LAND TO BE USED TEMPORARILY
  - SPECIAL CATEGORY LAND - REPLACEMENT LAND
  - FULL DCO PLOT EXTENT

Post Acceptance Amendments	LD	JB	17/06/19	C02
First Issue	SM	CH	16/04/19	C01
Revision Details	By	Check	Date	Suffix

**DCO APPLICATION**

Client: **Highways England**  
 Floor 5  
 Two Colmore Square  
 30 Colmore Circus  
 Birmingham  
 B4 6BN

Development Consent Order Number: **TR010022**

Project Title: **A38 DERBY JUNCTIONS**

Drawing Title: **SPECIAL CATEGORY LAND PLANS REGULATION 5(2)(i) SHEET 2 OF 10**

Designed	Drawn	Checked	Approved	Date
SM	LD	CH	SM	17/06/19

Internal Project No. 60533462  
 Scale @ A1 1:1250  
 Suitability D7  
 Zone Whole Scheme

THIS DOCUMENT HAS BEEN PREPARED PURSUANT TO AND IS SUBJECT TO THE TERMS OF AECOM'S APPOINTMENT BY ITS CLIENT. AECOM ACCEPTS NO LIABILITY FOR ANY USE OF THIS DOCUMENT OTHER THAN BY ITS ORIGINAL CLIENT OR FOLLOWING AECOM'S EXPRESS AGREEMENT TO SUCH USE, AND ONLY FOR THE PURPOSES FOR WHICH IT WAS PREPARED AND PROVIDED.

Drawing Number	Originator	Volume	Rev
HE514503 -ACM -DCO			C02
A38_SW_PR_ZZ	-DR-DC-9702		
Location	Type	Role	Number

This map is based upon Ordnance Survey material with the permission of Ordnance Survey on behalf of the Controller of Her Majesty's Stationary Office © Crown copyright. Unauthorised reproduction infringes Crown copyright and may lead to prosecution or civil proceedings. Highways England 100030649 2019.



Plot Date: 17 June 2019 14:48:42 File Name: G:\CAD\_IT\GIS COMMISSION DIRECTORY\A38 Derby - 302014 - Special Category Land Plans\HE514503-ACM-DCO-A38\_SW\_PR\_ZZ-DR-DC-9702.mxd

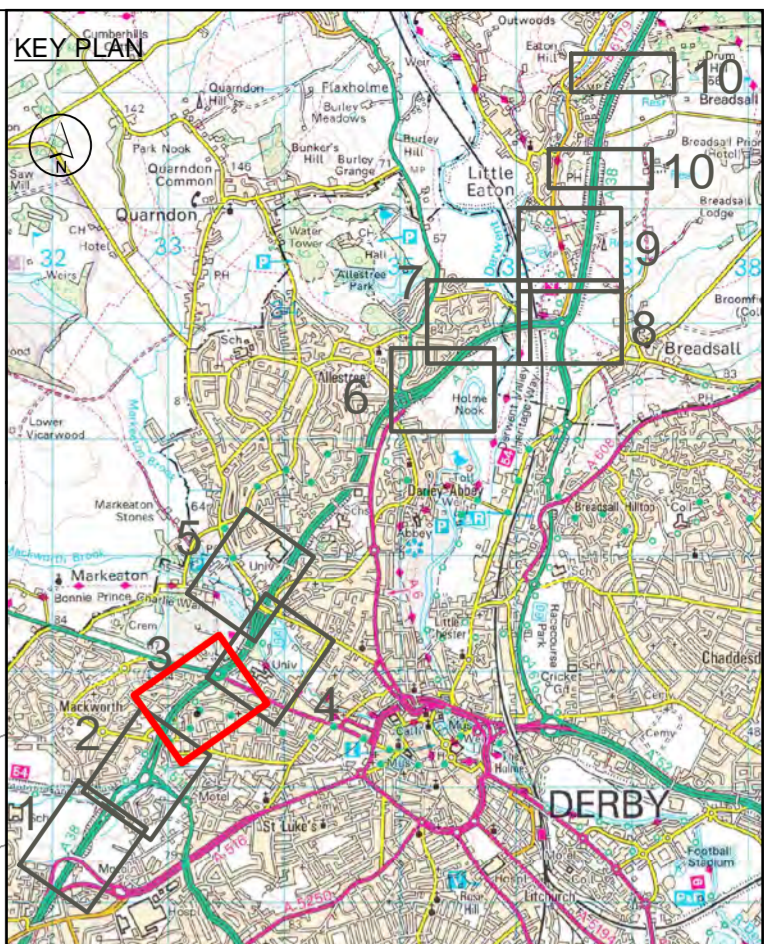
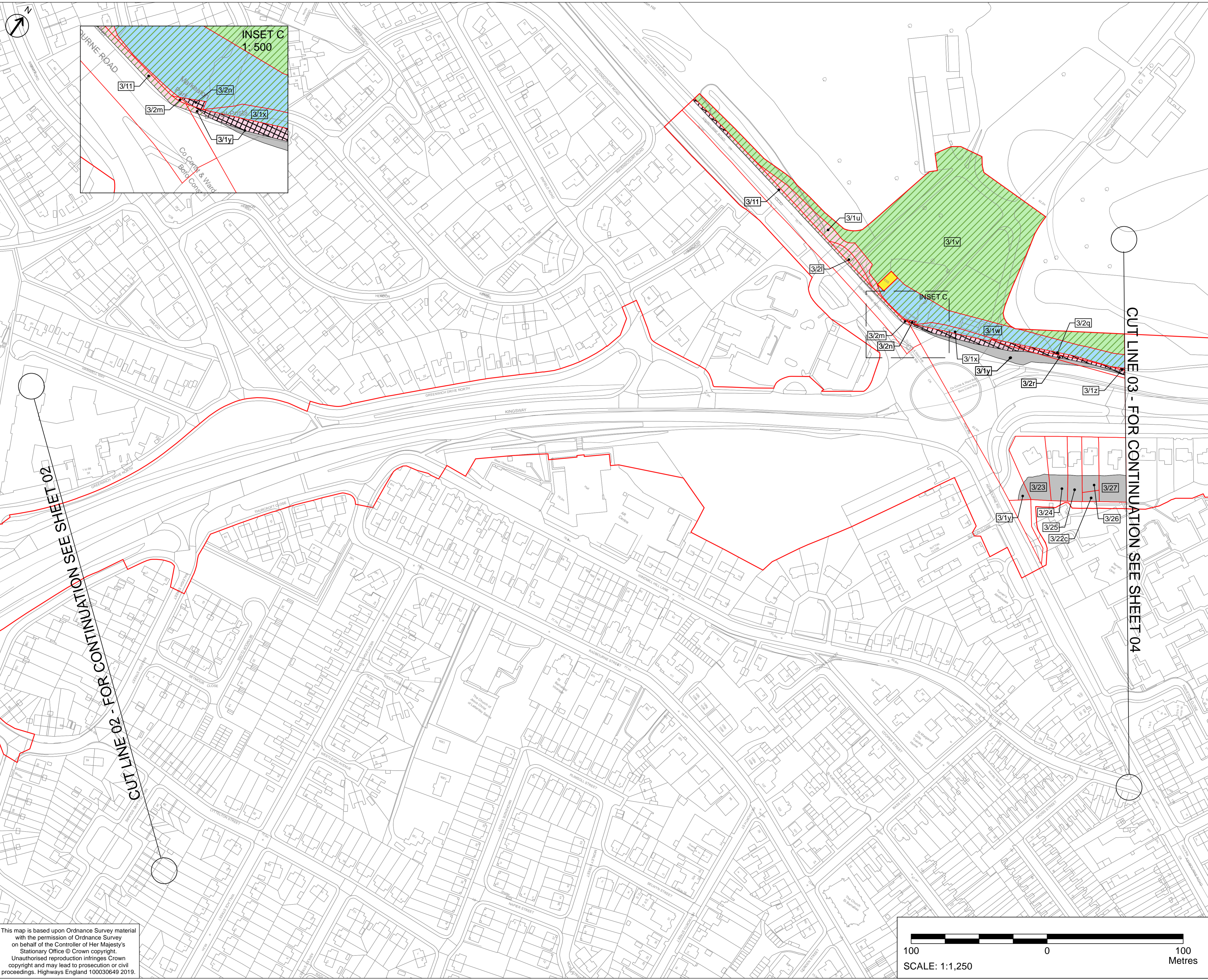

- NOTES**
1. ALL DIMENSIONS IN METRES UNLESS STATED OTHERWISE.
  2. DO NOT SCALE FROM THIS DRAWING, USE ONLY PRINTED DIMENSIONS.
  3. ALL EASEMENTS, SERVITUDES AND PRIVATE RIGHTS ARE PROPOSED TO BE EXTINGUISHED ON LAND THAT IS TO BE ACQUIRED UNLESS STATED OTHERWISE IN THE BOOK OF REFERENCE.
  4. THIS DRAWING IS TO BE READ IN CONJUNCTION WITH ALL OTHER PLANS AND DOCUMENTATION, IN PARTICULAR THE WORK PLANS AND THE BOOK OF REFERENCE.

- LEGEND**
- LIMITS OF LAND TO BE ACQUIRED OR USED PERMANENTLY OR TEMPORARILY (THE ORDER LIMITS)
  - 123 PLOT REFERENCE NUMBER (REFER TO BOOK OF REFERENCE FOR FURTHER INFORMATION)
  - LAND NOT INCLUDED WITHIN THE ORDER LIMITS
  - SPECIAL CATEGORY LAND - OPEN SPACE - LAND TO BE ACQUIRED PERMANENTLY
  - SPECIAL CATEGORY LAND - OPEN SPACE - LAND TO BE ACQUIRED PERMANENTLY AND RETAINED FOR USE AS OPEN SPACE
  - SPECIAL CATEGORY LAND - OPEN SPACE - LAND TO BE USED TEMPORARILY AND RIGHTS TO BE ACQUIRED PERMANENTLY
  - SPECIAL CATEGORY LAND - OPEN SPACE - LAND TO BE USED TEMPORARILY
  - SPECIAL CATEGORY LAND - REPLACEMENT LAND
  - FULL DCO PLOT EXTENT

Post Acceptance Amendments	SM	JB	17/06/19	C02
First Issue	SM	CH	16/04/19	C01
Revision Details	By	Check	Date	Suffix

**DCO APPLICATION**

Client: **Highways England**  
 Floor 5  
 Two Colmore Square  
 30 Colmore Circus  
 Birmingham  
 B4 6BN



Development Consent Order Number: **TR010022**

Project Title: **A38 DERBY JUNCTIONS**

Drawing Title: **SPECIAL CATEGORY LAND PLANS REGULATION 5(2)(i) SHEET 3 OF 10**

Designed	Drawn	Checked	Approved	Date
SM	LD	CH	SM	17/06/19

Internal Project No. 60533462  
 Scale @ A1 1:1250  
 Substation D7  
 Zone Whole Scheme

THIS DOCUMENT HAS BEEN PREPARED PURSUANT TO AND SUBJECT TO THE TERMS OF AECOM'S APPOINTMENT BY ITS CLIENT. AECOM ACCEPTS NO LIABILITY FOR ANY USE OF THIS DOCUMENT OTHER THAN BY ITS ORIGINAL CLIENT OR FOLLOWING AECOM'S EXPRESS AGREEMENT TO SUCH USE, AND ONLY FOR THE PURPOSES FOR WHICH IT WAS PREPARED AND PROVIDED.

Drawing Number	Originator	Volume	Rev
HE514503 -ACM -DCO	A38_SW_PR_ZZ	-DR-DC-9703	C02
Location	Type	Role	Number

CUT LINE 02 - FOR CONTINUATION SEE SHEET 02

CUT LINE 03 - FOR CONTINUATION SEE SHEET 04

This map is based upon Ordnance Survey material with the permission of Ordnance Survey on behalf of the Controller of Her Majesty's Stationary Office © Crown copyright. Unauthorised reproduction infringes Crown copyright and may lead to prosecution or civil proceedings. Highways England 100030649 2019.

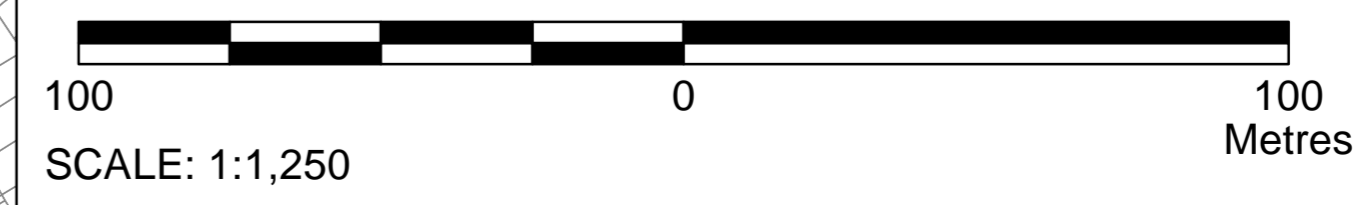

Plot Date: 17 June 2019 15:44:32  
 File Name: G:\CAD\_IT\GIS COMMISSION DIRECTORY\A38 Derby - 302014 - Special Category Land Plans\HE514503-ACM-DCO-A38\_SW\_PR\_ZZ-DR-DC-9703.mxd

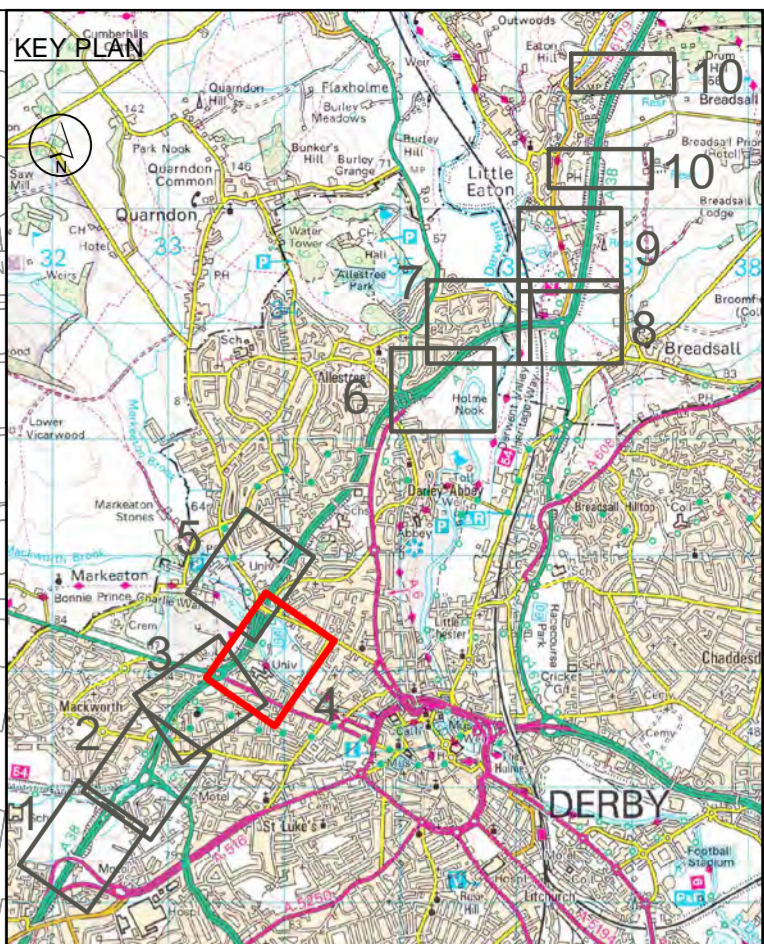

- NOTES**
1. ALL DIMENSIONS IN METRES UNLESS STATED OTHERWISE.
  2. DO NOT SCALE FROM THIS DRAWING, USE ONLY PRINTED DIMENSIONS.
  3. ALL EASEMENTS, SERVITUDES AND PRIVATE RIGHTS ARE PROPOSED TO BE EXTINGUISHED ON LAND THAT IS TO BE ACQUIRED UNLESS STATED OTHERWISE IN THE BOOK OF REFERENCE.
  4. THIS DRAWING IS TO BE READ IN CONJUNCTION WITH ALL OTHER PLANS AND DOCUMENTATION, IN PARTICULAR THE WORK PLANS AND THE BOOK OF REFERENCE.

- LEGEND**
- LIMITS OF LAND TO BE ACQUIRED OR USED PERMANENTLY OR TEMPORARILY (THE ORDER LIMITS)
  - 123 PLOT REFERENCE NUMBER (REFER TO BOOK OF REFERENCE FOR FURTHER INFORMATION)
  - LAND NOT INCLUDED WITHIN THE ORDER LIMITS
  - SPECIAL CATEGORY LAND - OPEN SPACE - LAND TO BE ACQUIRED PERMANENTLY
  - SPECIAL CATEGORY LAND - OPEN SPACE - LAND TO BE ACQUIRED PERMANENTLY AND RETAINED FOR USE AS OPEN SPACE
  - SPECIAL CATEGORY LAND - OPEN SPACE - LAND TO BE USED TEMPORARILY AND RIGHTS TO BE ACQUIRED PERMANENTLY
  - SPECIAL CATEGORY LAND - OPEN SPACE - LAND TO BE USED TEMPORARILY
  - SPECIAL CATEGORY LAND - REPLACEMENT LAND
  - FULL DCO PLOT EXTENT

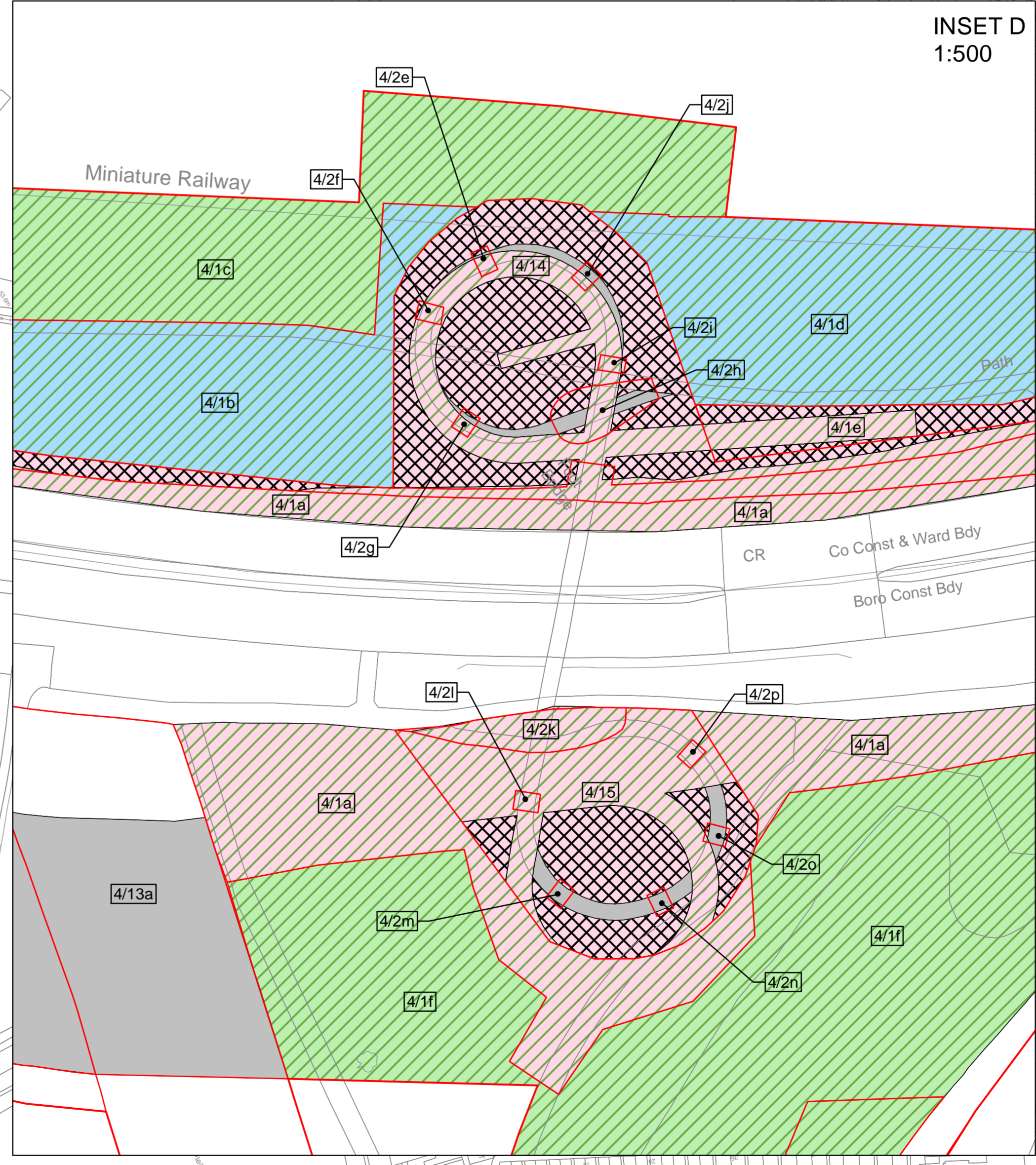

Post Acceptance Amendments	SM	JB	17/06/19	C02
First Issue	SM	CH	16/04/19	C01
Revision Details	By	Check	Date	Suffix

**DCO APPLICATION**

Client: **Highways England**  
 Floor 5  
 Two Colmore Square  
 30 Colmore Circus  
 Birmingham  
 B4 6BN



Development Consent Order Number: **TR010022**

Project Title: **A38 DERBY JUNCTIONS**

Drawing Title: **SPECIAL CATEGORY LAND PLANS REGULATION 5(2)(i) SHEET 4 OF 10**

Designed SM	Drawn LD	Checked CH	Approved SM	Date 17/06/19
Internal Project No. 60533462	Suitability D7	Scale @ A1 1:1250	Zone Whole Scheme	

THIS DOCUMENT HAS BEEN PREPARED PURSUANT TO AND SUBJECT TO THE TERMS OF AECOM'S APPOINTMENT BY ITS CLIENT. AECOM ACCEPTS NO LIABILITY FOR ANY USE OF THIS DOCUMENT OTHER THAN BY ITS ORIGINAL CLIENT OR FOLLOWING AECOM'S EXPRESS AGREEMENT TO SUCH USE, AND ONLY FOR THE PURPOSES FOR WHICH IT WAS PREPARED AND PROVIDED.

Drawing Number: HE514503	Originator: -ACM	Volume: -DCO	Rev: C02
A38_SW_PR_ZZ	-DR-DC-9704		
Location:	Type:   Role:   Number:		

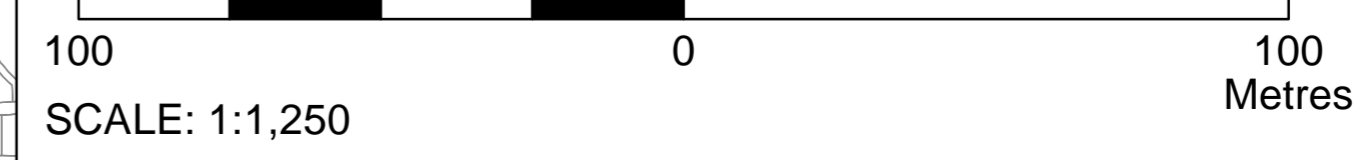

This map is based upon Ordnance Survey material with the permission of Ordnance Survey on behalf of the Controller of Her Majesty's Stationary Office © Crown copyright. Unauthorised reproduction infringes Crown copyright and may lead to prosecution or civil proceedings. Highways England 100030649 2019.

Plot Date: 17 June 2019 17:10:14 File Name: G:\CAD\_IT\GIS COMMISSION DIRECTOR\A38 Derby - 302014 - Special Category Land Plans\HE514503-ACM-DCO-A38\_SW\_PR\_ZZ-DR-DC-9704.mxd

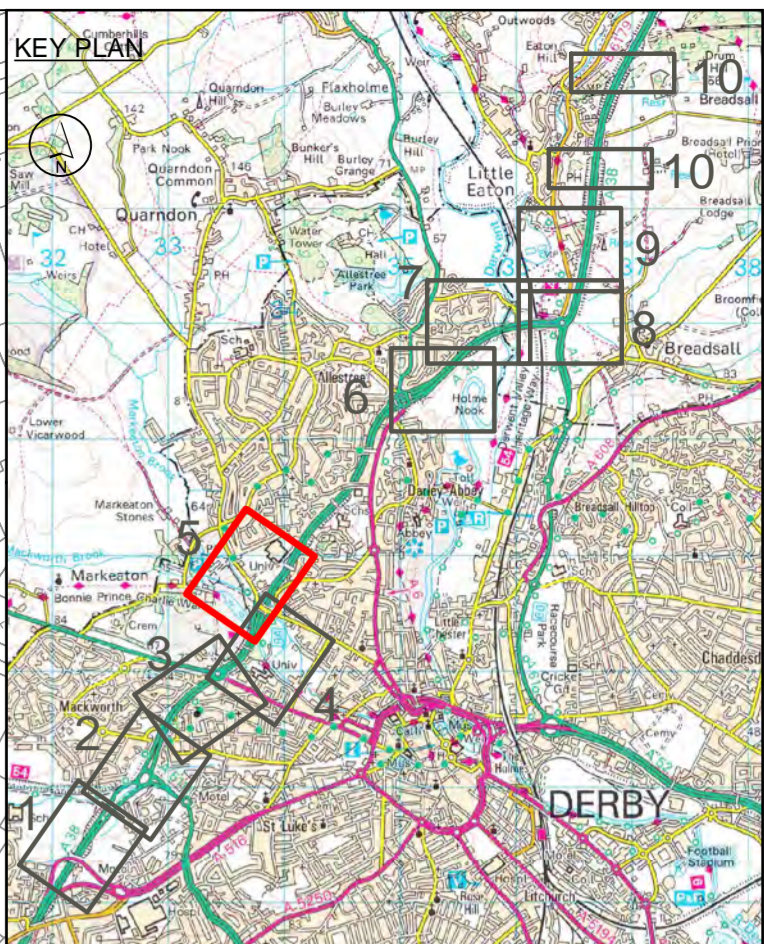

- NOTES**
1. ALL DIMENSIONS IN METRES UNLESS STATED OTHERWISE.
  2. DO NOT SCALE FROM THIS DRAWING, USE ONLY PRINTED DIMENSIONS.
  3. ALL EASEMENTS, SERVITUDES AND PRIVATE RIGHTS ARE PROPOSED TO BE EXTINGUISHED ON LAND THAT IS TO BE ACQUIRED UNLESS STATED OTHERWISE IN THE BOOK OF REFERENCE.
  4. THIS DRAWING IS TO BE READ IN CONJUNCTION WITH ALL OTHER PLANS AND DOCUMENTATION, IN PARTICULAR THE WORK PLANS AND THE BOOK OF REFERENCE.

- LEGEND**
- LIMITS OF LAND TO BE ACQUIRED OR USED PERMANENTLY OR TEMPORARILY (THE ORDER LIMITS)
  - 123 PLOT REFERENCE NUMBER (REFER TO BOOK OF REFERENCE FOR FURTHER INFORMATION)
  - LAND NOT INCLUDED WITHIN THE ORDER LIMITS
  - SPECIAL CATEGORY LAND - OPEN SPACE - LAND TO BE ACQUIRED PERMANENTLY
  - SPECIAL CATEGORY LAND - OPEN SPACE - LAND TO BE ACQUIRED PERMANENTLY AND RETAINED FOR USE AS OPEN SPACE
  - SPECIAL CATEGORY LAND - OPEN SPACE - LAND TO BE USED TEMPORARILY AND RIGHTS TO BE ACQUIRED PERMANENTLY
  - SPECIAL CATEGORY LAND - OPEN SPACE - LAND TO BE USED TEMPORARILY
  - SPECIAL CATEGORY LAND - REPLACEMENT LAND
  - FULL DCO PLOT EXTENT

Revision Details	By	Check	Date	Suffix
Post Acceptance Amendments	SM	JB	17/06/19	C02
First Issue	SM	CH	16/04/19	C01

**DCO APPLICATION**

Client: **Highways England**  
 Floor 5  
 Two Colonnade Square  
 30 Colonnade Circus  
 Birmingham  
 B4 6BN



Development Consent Order Number: **TR010022**

Project Title: **A38 DERBY JUNCTIONS**

Drawing Title: **SPECIAL CATEGORY LAND PLANS REGULATION 5(2)(i) SHEET 5 OF 10**

Designed SM	Drawn LD	Checked CH	Approved SM	Date 17/06/19
Internal Project No. 60533462			Suitability D7	
Scale @ A1 1:1250			Zone Whole Scheme	

THIS DOCUMENT HAS BEEN PREPARED PURSUANT TO AND SUBJECT TO THE TERMS OF AECOM'S APPOINTMENT BY ITS CLIENT. AECOM ACCEPTS NO LIABILITY FOR ANY USE OF THIS DOCUMENT OTHER THAN BY ITS ORIGINAL CLIENT OR FOLLOWING AECOM'S EXPRESS AGREEMENT TO SUCH USE, AND ONLY FOR THE PURPOSES FOR WHICH IT WAS PREPARED AND PROVIDED.

Drawing Number: HE514503	Originator: -ACM	Volume: -DCO	Rev: C02
A38_SW_PR_ZZ	-DR-DC-9705		
Location	Type	Role	Number

This map is based upon Ordnance Survey material with the permission of Ordnance Survey on behalf of the Controller of Her Majesty's Stationary Office © Crown copyright. Unauthorised reproduction infringes Crown copyright and may lead to prosecution or civil proceedings. Highways England 100030649 2019.

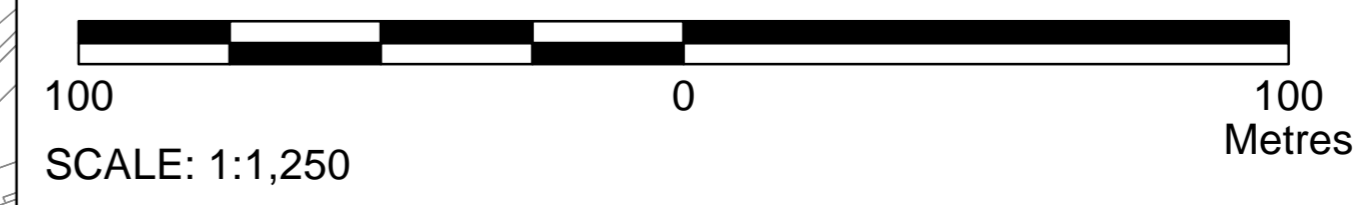

Plot Date: 18 June 2019 09:34:12 File Name: G:\CAD\_IT\GIS\COMMISSION DIRECTORY\A38 Derby - 302014 - Special Category Land Plans\HE514503-ACM-DCO-A38\_SW\_PR\_ZZ-DR-DC-9705.mxd



CUTLINE 05 - FOR CONTINUATION SEE SHEET 07

**SHEET NOT USED AS PART OF THIS DRAWING SERIES**

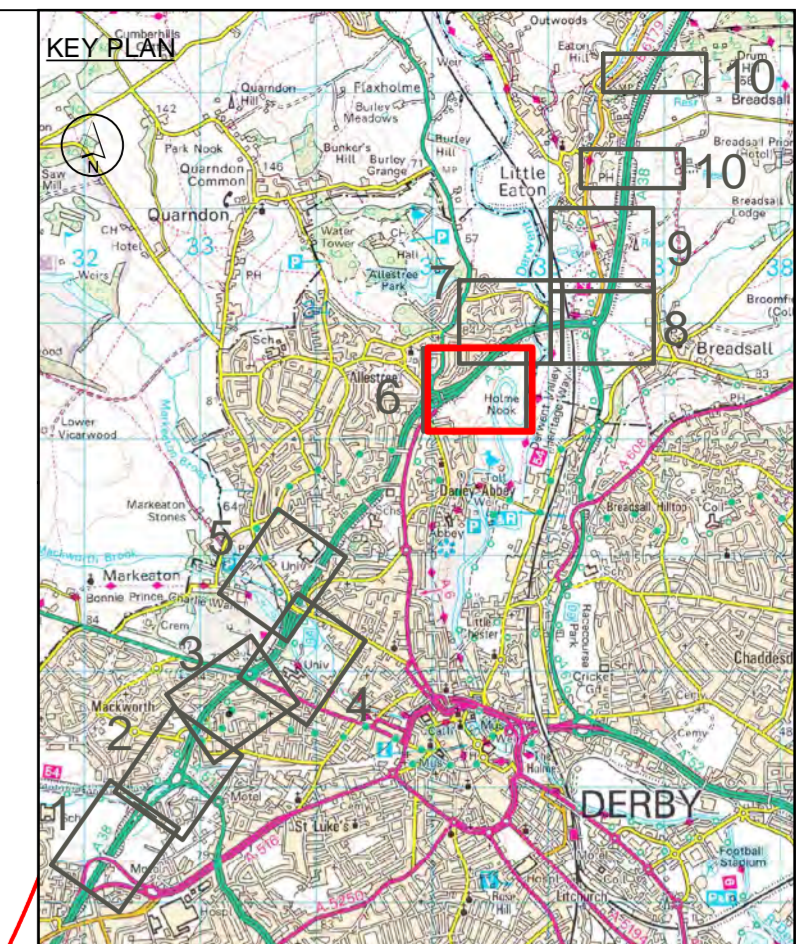

- NOTES**
1. ALL DIMENSIONS IN METRES UNLESS STATED OTHERWISE.
  2. DO NOT SCALE FROM THIS DRAWING, USE ONLY PRINTED DIMENSIONS.
  3. ALL EASEMENTS, SERVITUDES AND PRIVATE RIGHTS ARE PROPOSED TO BE EXTINGUISHED ON LAND THAT IS TO BE ACQUIRED UNLESS STATED OTHERWISE IN THE BOOK OF REFERENCE.
  4. THIS DRAWING IS TO BE READ IN CONJUNCTION WITH ALL OTHER PLANS AND DOCUMENTATION, IN PARTICULAR THE WORK PLANS AND THE BOOK OF REFERENCE.

- LEGEND**
- LIMITS OF LAND TO BE ACQUIRED OR USED PERMANENTLY OR TEMPORARILY (THE ORDER LIMITS)
  - 123 PLOT REFERENCE NUMBER (REFER TO BOOK OF REFERENCE FOR FURTHER INFORMATION)
  - LAND NOT INCLUDED WITHIN THE ORDER LIMITS
  - SPECIAL CATEGORY LAND - OPEN SPACE - LAND TO BE ACQUIRED PERMANENTLY
  - SPECIAL CATEGORY LAND - OPEN SPACE - LAND TO BE ACQUIRED PERMANENTLY AND RETAINED FOR USE AS OPEN SPACE
  - SPECIAL CATEGORY LAND - OPEN SPACE - LAND TO BE USED TEMPORARILY AND RIGHTS TO BE ACQUIRED PERMANENTLY
  - SPECIAL CATEGORY LAND - OPEN SPACE - LAND TO BE USED TEMPORARILY
  - SPECIAL CATEGORY LAND - REPLACEMENT LAND
  - FULL DCO PLOT EXTENT

Revision Details	By	Check	Date	Suffix
Post Acceptance Amendments	SM	JB	17/06/19	C02
First Issue	SM	CH	16/04/19	C01

**DCO APPLICATION**

Client  
**Highways England**  
 Floor 5  
 Two Colmore Square  
 30 Colmore Circus  
 Birmingham  
 B4 6BN



Development Consent Order Number  
**TR010022**

Project Title  
**A38 DERBY JUNCTIONS**

Drawing Title  
**SPECIAL CATEGORY LAND PLANS REGULATION 5(2)(i) SHEET 6 OF 10**

Designed	Drawn	Checked	Approved	Date
SM	LD	CH	SM	17/06/19

Internal Project No. 60533462  
 Scale @ A1 1:1250  
 Suitability D7  
 Zone Whole Scheme

THIS DOCUMENT HAS BEEN PREPARED PURSUANT TO AND SUBJECT TO THE TERMS OF AECOM'S APPOINTMENT BY ITS CLIENT. AECOM ACCEPTS NO LIABILITY FOR ANY USE OF THIS DOCUMENT OTHER THAN BY ITS ORIGINAL CLIENT OR FOLLOWING AECOM'S EXPRESS AGREEMENT TO SUCH USE, AND ONLY FOR THE PURPOSES FOR WHICH IT WAS PREPARED AND PROVIDED.

Drawing Number	Originator	Volume	Rev
HE514503 -ACM -DCO	A38_SW_PR_ZZ	-DR-DC-9706	C02



Plot Date: 18 June 2019 09:48:28  
 File Name: G:\CAD\_IT\GIS\COMMISSION DIRECTOR\A38 Derby - 302014 - Special Category Land Plans\HE514503-ACM-DCO-A38\_SW\_PR\_ZZ-DR-DC-9706.mxd

This map is based upon Ordnance Survey material with the permission of Ordnance Survey on behalf of the Controller of Her Majesty's Stationary Office © Crown copyright. Unauthorised reproduction infringes Crown copyright and may lead to prosecution or civil proceedings. Highways England 100030649 2019.

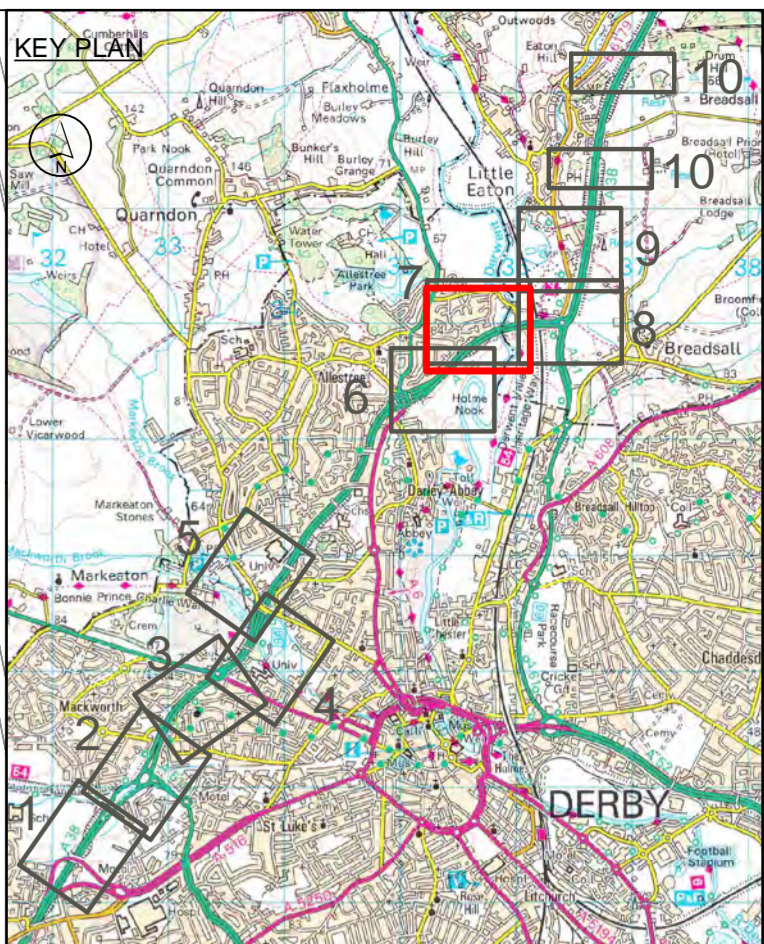
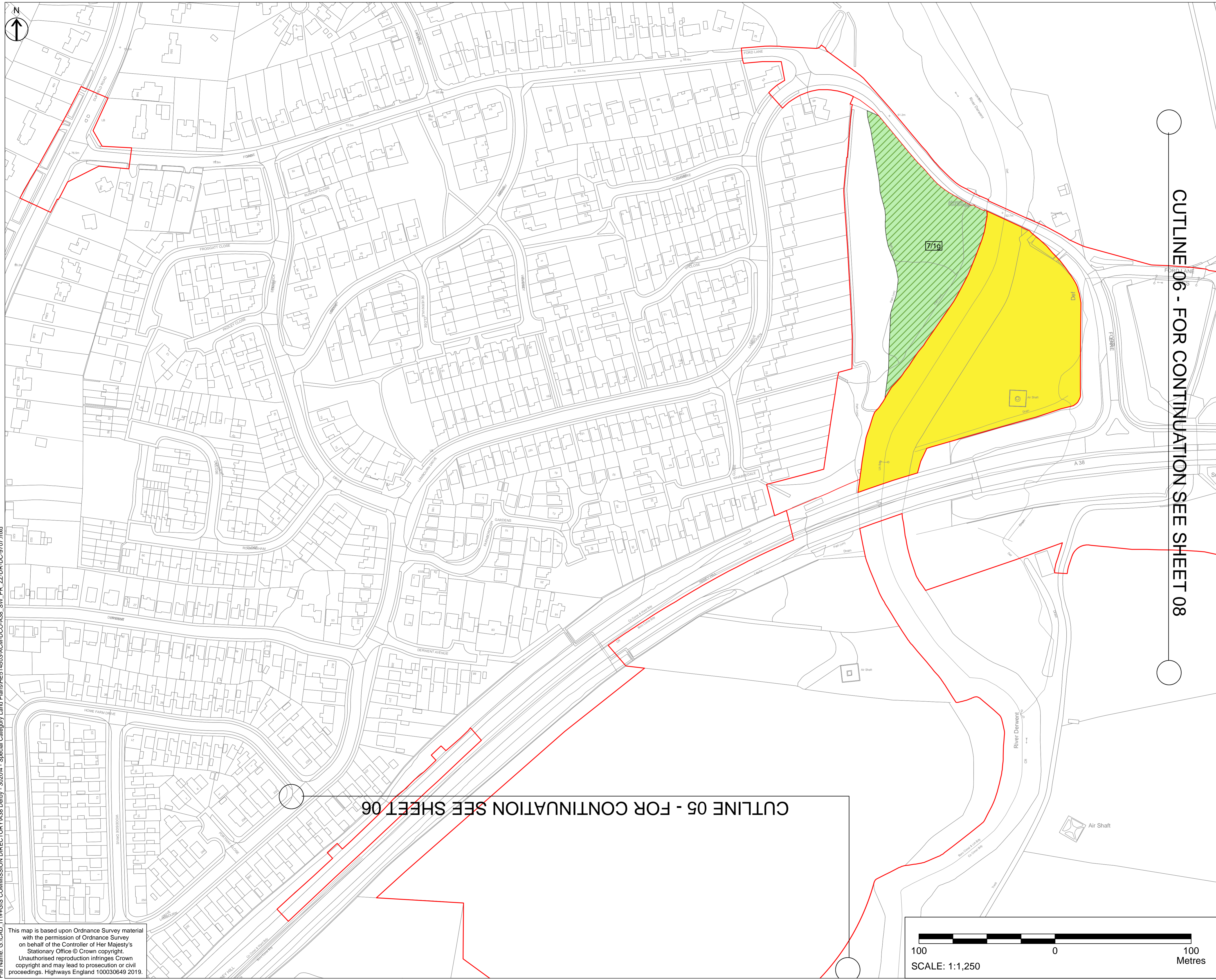
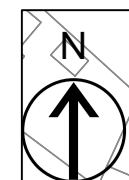

- NOTES**
1. ALL DIMENSIONS IN METRES UNLESS STATED OTHERWISE.
  2. DO NOT SCALE FROM THIS DRAWING, USE ONLY PRINTED DIMENSIONS.
  3. ALL EASEMENTS, SERVITUDES AND PRIVATE RIGHTS ARE PROPOSED TO BE EXTINGUISHED ON LAND THAT IS TO BE ACQUIRED UNLESS STATED OTHERWISE IN THE BOOK OF REFERENCE.
  4. THIS DRAWING IS TO BE READ IN CONJUNCTION WITH ALL OTHER PLANS AND DOCUMENTATION, IN PARTICULAR THE WORK PLANS AND THE BOOK OF REFERENCE.

- LEGEND**
- LIMITS OF LAND TO BE ACQUIRED OR USED PERMANENTLY OR TEMPORARILY (THE ORDER LIMITS)
  - 123 PLOT REFERENCE NUMBER (REFER TO BOOK OF REFERENCE FOR FURTHER INFORMATION)
  - LAND NOT INCLUDED WITHIN THE ORDER LIMITS
  - SPECIAL CATEGORY LAND - OPEN SPACE - LAND TO BE ACQUIRED PERMANENTLY
  - SPECIAL CATEGORY LAND - OPEN SPACE - LAND TO BE ACQUIRED PERMANENTLY AND RETAINED FOR USE AS OPEN SPACE
  - SPECIAL CATEGORY LAND - OPEN SPACE - LAND TO BE USED TEMPORARILY AND RIGHTS TO BE ACQUIRED PERMANENTLY
  - SPECIAL CATEGORY LAND - OPEN SPACE - LAND TO BE USED TEMPORARILY
  - SPECIAL CATEGORY LAND - REPLACEMENT LAND
  - FULL DCO PLOT EXTENT

CUTLINE 06 - FOR CONTINUATION SEE SHEET 08

CUTLINE 05 - FOR CONTINUATION SEE SHEET 06

Post Acceptance Amendments	SM	JB	17/06/19	C02
First Issue	SM	CH	16/04/19	C01
Revision Details	By	Check	Date	Suffix

**DCO APPLICATION**

Client  
**Highways England**  
Two Colmore Square  
30 Colmore Circus  
Birmingham  
B4 6BN



Development Consent Order Number  
**TR010022**

Project Title  
**A38  
DERBY JUNCTIONS**

Drawing Title  
**SPECIAL CATEGORY  
LAND PLANS  
REGULATION 5(2)(i)  
SHEET 7 OF 10**

Designed SM	Drawn LD	Checked CH	Approved SM	Date 17/06/19
Internal Project No. 60533462		Suitability D7		
Scale @ A1 1:1250		Zone Whole Scheme		

THIS DOCUMENT HAS BEEN PREPARED PURSUANT TO AND SUBJECT TO THE TERMS OF AECOM'S APPOINTMENT BY ITS CLIENT. AECOM ACCEPTS NO LIABILITY FOR ANY USE OF THIS DOCUMENT OTHER THAN BY ITS ORIGINAL CLIENT OR FOLLOWING AECOM'S EXPRESS AGREEMENT TO SUCH USE, AND ONLY FOR THE PURPOSES FOR WHICH IT WAS PREPARED AND PROVIDED.

Drawing Number HE514503	Originator -ACM	Volume -DCO	Rev C02
A38_SW_PR_ZZ		-DR-DC-9707	
Location	Type	Role	Number

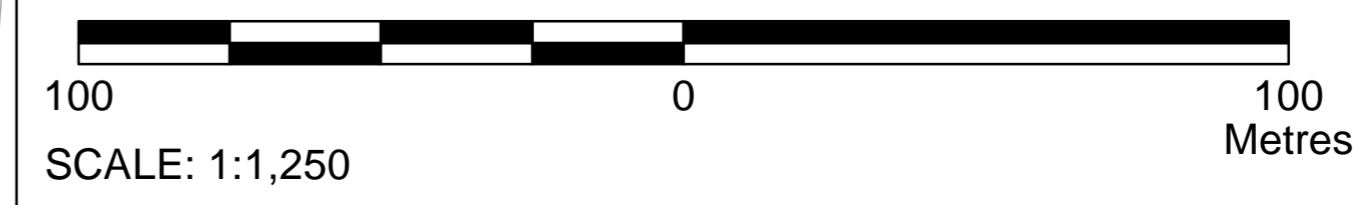

Plot Date: 18 June 2019 12:23:30  
File Name: G:\CAD\_IT\GIS\COMMISSION DIRECTORY\A38 Derby - 302014 - Special Category Land Plans\HE514503-ACM-DCO-A38\_SW\_PR\_ZZ-DR-DC-9707.mxd

This map is based upon Ordnance Survey material with the permission of Ordnance Survey on behalf of the Controller of Her Majesty's Stationary Office © Crown copyright. Unauthorised reproduction infringes Crown copyright and may lead to prosecution or civil proceedings. Highways England 100030649 2019.



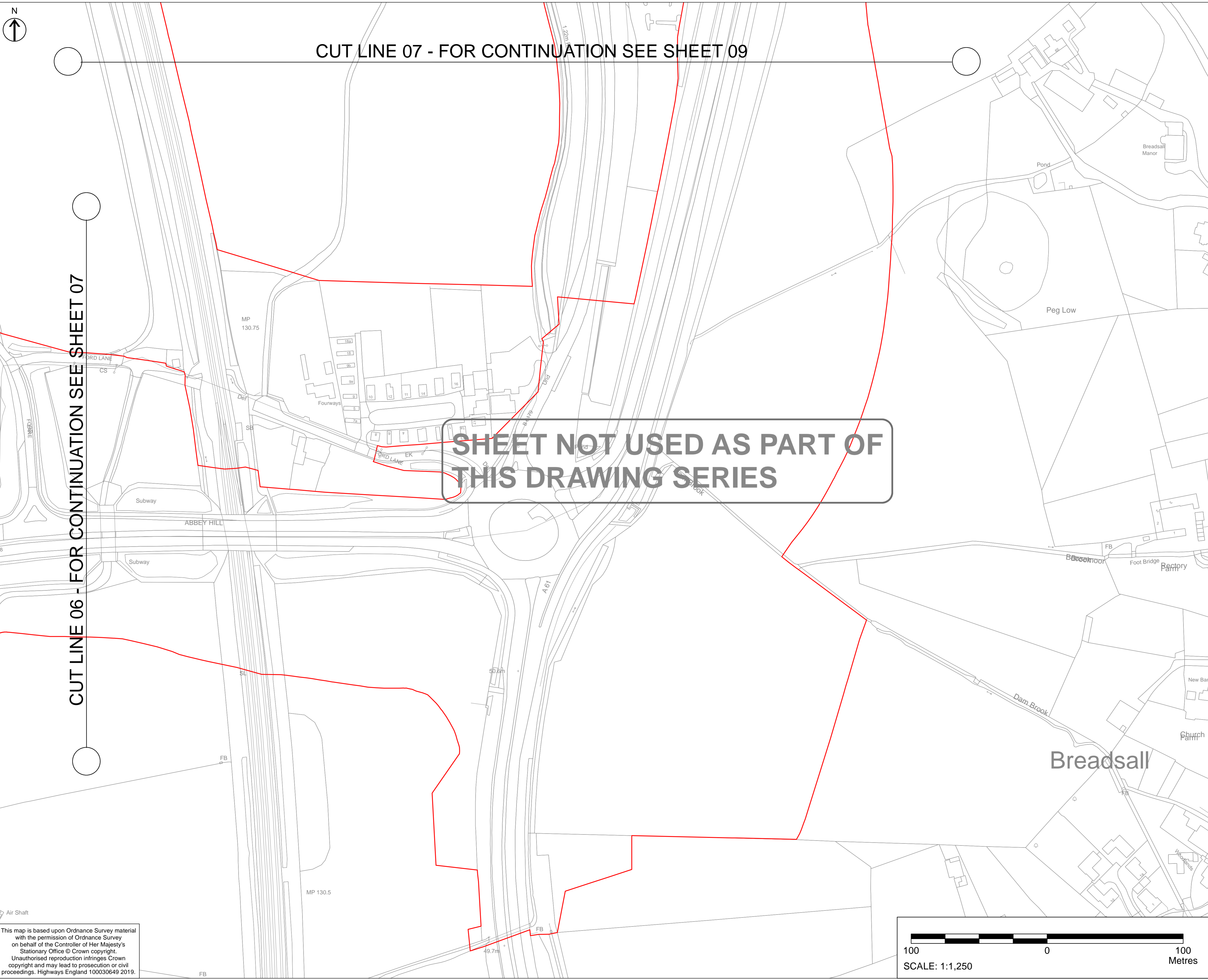

CUT LINE 07 - FOR CONTINUATION SEE SHEET 09

CUT LINE 06 - FOR CONTINUATION SEE SHEET 07

**SHEET NOT USED AS PART OF THIS DRAWING SERIES**

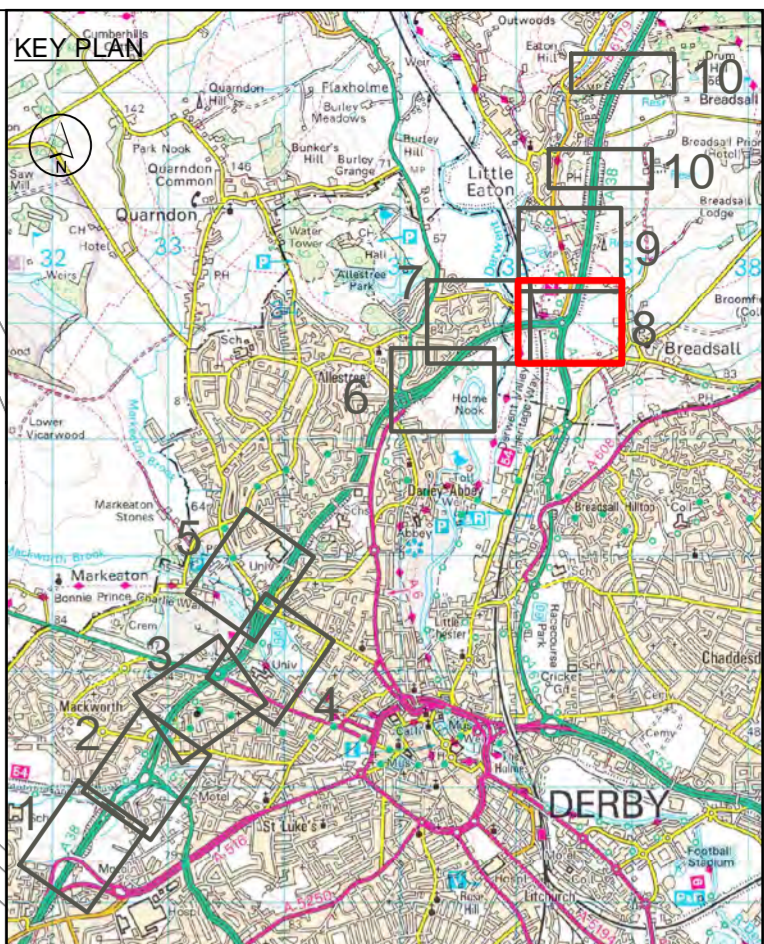

- NOTES**
1. ALL DIMENSIONS IN METRES UNLESS STATED OTHERWISE.
  2. DO NOT SCALE FROM THIS DRAWING, USE ONLY PRINTED DIMENSIONS.
  3. ALL EASEMENTS, SERVITUDES AND PRIVATE RIGHTS ARE PROPOSED TO BE EXTINGUISHED ON LAND THAT IS TO BE ACQUIRED UNLESS STATED OTHERWISE IN THE BOOK OF REFERENCE.
  4. THIS DRAWING IS TO BE READ IN CONJUNCTION WITH ALL OTHER PLANS AND DOCUMENTATION, IN PARTICULAR THE WORK PLANS AND THE BOOK OF REFERENCE.

- LEGEND**
- LIMITS OF LAND TO BE ACQUIRED OR USED PERMANENTLY OR TEMPORARILY (THE ORDER LIMITS)
  - 123 PLOT REFERENCE NUMBER (REFER TO BOOK OF REFERENCE FOR FURTHER INFORMATION)
  - LAND NOT INCLUDED WITHIN THE ORDER LIMITS
  - SPECIAL CATEGORY LAND - OPEN SPACE - LAND TO BE ACQUIRED PERMANENTLY
  - SPECIAL CATEGORY LAND - OPEN SPACE - LAND TO BE ACQUIRED PERMANENTLY AND RETAINED FOR USE AS OPEN SPACE
  - SPECIAL CATEGORY LAND - OPEN SPACE - LAND TO BE USED TEMPORARILY AND RIGHTS TO BE ACQUIRED PERMANENTLY
  - SPECIAL CATEGORY LAND - OPEN SPACE - LAND TO BE USED TEMPORARILY
  - SPECIAL CATEGORY LAND - REPLACEMENT LAND
  - FULL DCO PLOT EXTENT

Revision Details	By	Check	Date	Suffix
Post Acceptance Amendments	SM	JB	17/06/19	C02
First Issue	SM	CH	16/04/19	C01

**DCO APPLICATION**

Client: **Highways England**  
 Floor 5  
 Two Colmore Square  
 30 Colmore Circus  
 Birmingham  
 B4 6BN



Development Consent Order Number: **TR010022**

Project Title: **A38 DERBY JUNCTIONS**

Drawing Title: **SPECIAL CATEGORY LAND PLANS REGULATION 5(2)(i) SHEET 8 OF 10**

Designed	Drawn	Checked	Approved	Date
SM	LD	CH	SM	17/06/19

Internal Project No. 60533462  
 Scale @ A1 1:1250  
 Suitability D7  
 Zone Whole Scheme

THIS DOCUMENT HAS BEEN PREPARED PURSUANT TO AND SUBJECT TO THE TERMS OF AECOM'S APPOINTMENT BY ITS CLIENT. AECOM ACCEPTS NO LIABILITY FOR ANY USE OF THIS DOCUMENT OTHER THAN BY ITS ORIGINAL CLIENT OR FOLLOWING AECOM'S EXPRESS AGREEMENT TO SUCH USE, AND ONLY FOR THE PURPOSES FOR WHICH IT WAS PREPARED AND PROVIDED.			
Drawing Number HE514503	Originator -ACM	Volume -DCO	Rev C02
A38_SW_PR_ZZ		-DR-DC-9708	
Location	Type	Role	Number

Plot Date: 18 June 2019 11:57:08  
 File Name: G:\CAD\_IT\GIS COMMISSION DIRECTORY\A38 Derby - 302014 - Special Category Land Plans\HE514503-ACM-DCO-A38\_SW\_PR\_ZZ-DR-DC-9708.mxd  
 This map is based upon Ordnance Survey material with the permission of Ordnance Survey on behalf of the Controller of Her Majesty's Stationary Office © Crown copyright. Unauthorised reproduction infringes Crown copyright and may lead to prosecution or civil proceedings. Highways England 100030649 2019.



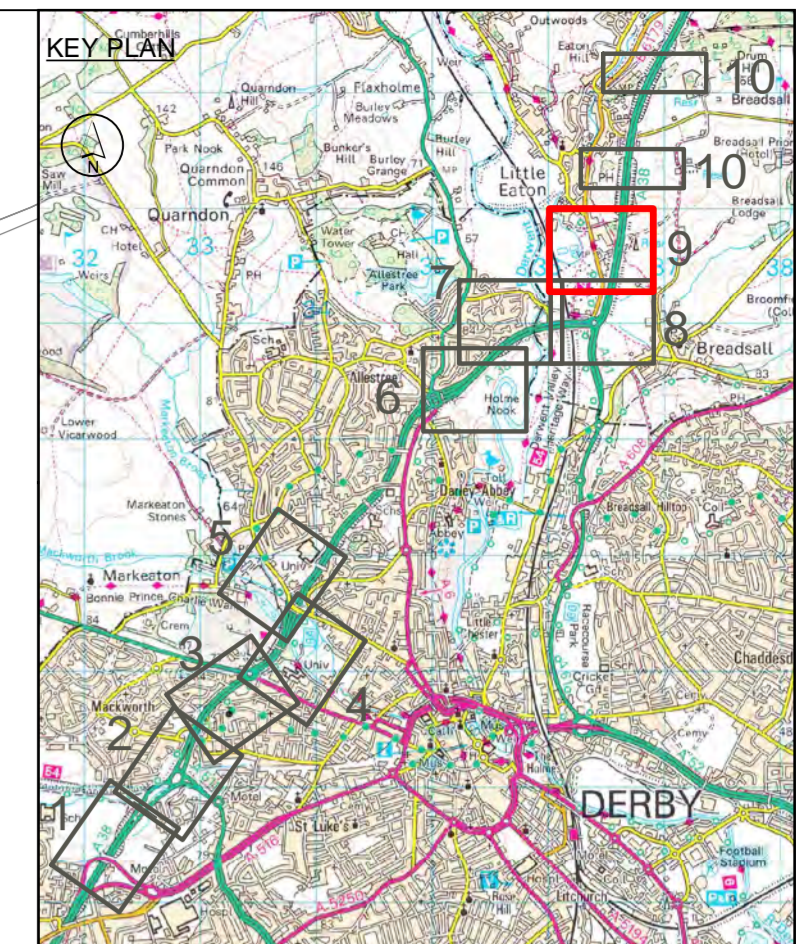
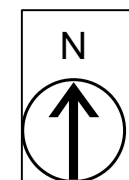

**NOTES**

1. ALL DIMENSIONS IN METRES UNLESS STATED OTHERWISE.
2. DO NOT SCALE FROM THIS DRAWING, USE ONLY PRINTED DIMENSIONS.
3. ALL EASEMENTS, SERVITUDES AND PRIVATE RIGHTS ARE PROPOSED TO BE EXTINGUISHED ON LAND THAT IS TO BE ACQUIRED UNLESS STATED OTHERWISE IN THE BOOK OF REFERENCE.
4. THIS DRAWING IS TO BE READ IN CONJUNCTION WITH ALL OTHER PLANS AND DOCUMENTATION, IN PARTICULAR THE WORK PLANS AND THE BOOK OF REFERENCE.

**LEGEND**

- LIMITS OF LAND TO BE ACQUIRED OR USED PERMANENTLY OR TEMPORARILY (THE ORDER LIMITS)
- 123 PLOT REFERENCE NUMBER (REFER TO BOOK OF REFERENCE FOR FURTHER INFORMATION)
- LAND NOT INCLUDED WITHIN THE ORDER LIMITS
- SPECIAL CATEGORY LAND - OPEN SPACE - LAND TO BE ACQUIRED PERMANENTLY
- SPECIAL CATEGORY LAND - OPEN SPACE - LAND TO BE ACQUIRED PERMANENTLY AND RETAINED FOR USE AS OPEN SPACE
- SPECIAL CATEGORY LAND - OPEN SPACE - LAND TO BE USED TEMPORARILY AND RIGHTS TO BE ACQUIRED PERMANENTLY
- SPECIAL CATEGORY LAND - OPEN SPACE - LAND TO BE USED TEMPORARILY
- SPECIAL CATEGORY LAND - REPLACEMENT LAND
- FULL DCO PLOT EXTENT

Revision Details	By	Check	Date	Suffix
Post Acceptance Amendments	SM	JB	17/06/19	C02
First Issue	SM	CH	16/04/19	C01

**DCO APPLICATION**

Client  
**Highways England**  
 Floor 5  
 Two Colmore Square  
 30 Colmore Circus  
 Birmingham  
 B4 6BN



Development Consent Order Number  
**TR010022**

Project Title  
**A38  
 DERBY JUNCTIONS**

Drawing Title  
**SPECIAL CATEGORY  
 LAND PLANS  
 REGULATION 5(2)(i)  
 SHEET 9 OF 10**

Designed SM	Drawn LD	Checked CH	Approved SM	Date 16/04/19
Internal Project No. 60533462			Suitability D7	
Scale @ A1 1:1250			Zone Whole Scheme	

THIS DOCUMENT HAS BEEN PREPARED PURSUANT TO AND SUBJECT TO THE TERMS OF AECOM'S APPOINTMENT BY ITS CLIENT. AECOM ACCEPTS NO LIABILITY FOR ANY USE OF THIS DOCUMENT OTHER THAN BY ITS ORIGINAL CLIENT OR FOLLOWING AECOM'S EXPRESS AGREEMENT TO SUCH USE, AND ONLY FOR THE PURPOSES FOR WHICH IT WAS PREPARED AND PROVIDED.

Drawing Number HE514503	Originator -ACM	Volume -DCO	Rev C02
A38_SW_PR_ZZ		-DR-DC-9709	
Location	Type	Role	Number

**SHEET NOT USED AS PART OF THIS DRAWING SERIES**

**CUTLINE 07 - FOR CONTINUATION SEE SHEET 08**

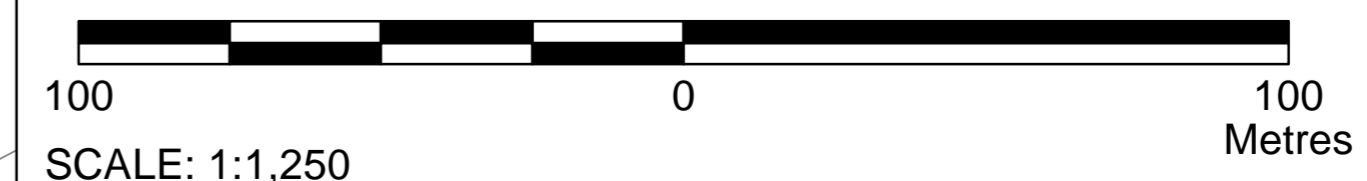

Plot Date: 18 June 2019 12:28:34 File Name: G:\CAD\_IT\GIS\COMMISSION\DIRECTOR\A38 Derby - 302014 - Special Category Land Plans\HE514503-ACM-DCO-A38\_SW\_PR\_ZZ-DR-DC-9709.mxd

This map is based upon Ordnance Survey material with the permission of Ordnance Survey on behalf of the Controller of Her Majesty's Stationary Office © Crown copyright. Unauthorised reproduction infringes Crown copyright and may lead to prosecution or civil proceedings. Highways England 100030649 2019.

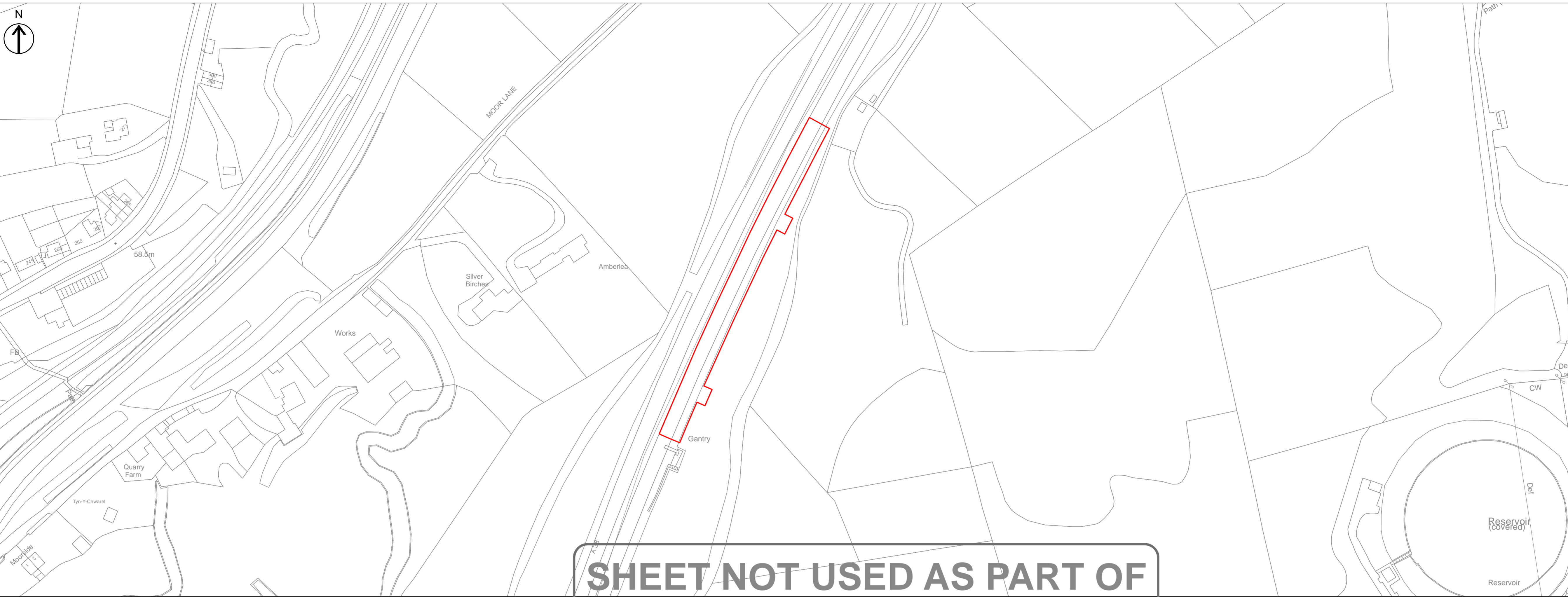

**SHEET NOT USED AS PART OF THIS DRAWING SERIES**

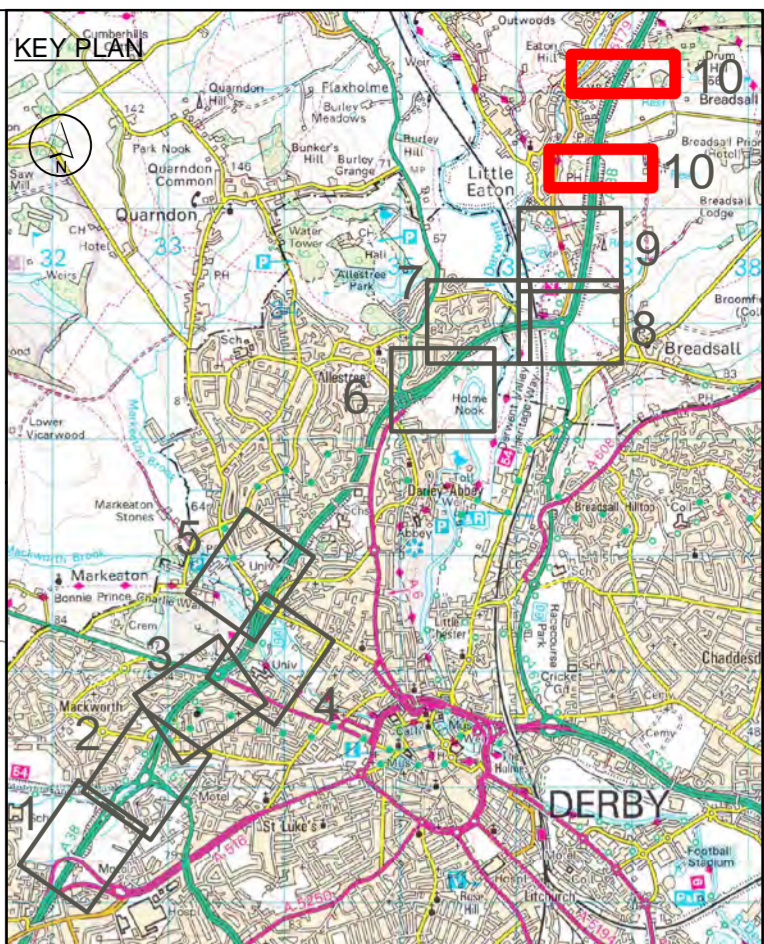
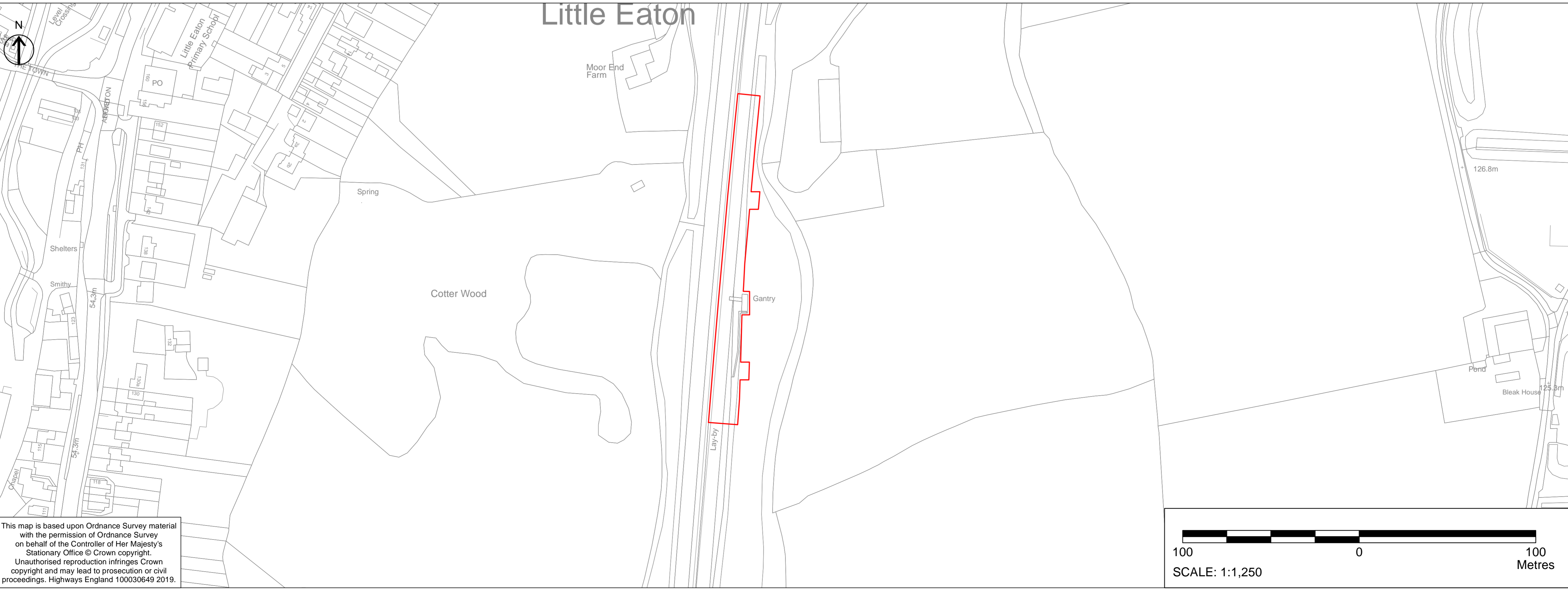

- NOTES**
1. ALL DIMENSIONS IN METRES UNLESS STATED OTHERWISE.
  2. DO NOT SCALE FROM THIS DRAWING. USE ONLY PRINTED DIMENSIONS.
  3. ALL EASEMENTS, SERVITUDES AND PRIVATE RIGHTS ARE PROPOSED TO BE EXTINGUISHED ON LAND THAT IS TO BE ACQUIRED UNLESS STATED OTHERWISE IN THE BOOK OF REFERENCE.
  4. THIS DRAWING IS TO BE READ IN CONJUNCTION WITH ALL OTHER PLANS AND DOCUMENTATION, IN PARTICULAR THE WORK PLANS AND THE BOOK OF REFERENCE.

- LEGEND**
- LIMITS OF LAND TO BE ACQUIRED OR USED PERMANENTLY OR TEMPORARILY (THE ORDER LIMITS)
  - 123 PLOT REFERENCE NUMBER (REFER TO BOOK OF REFERENCE FOR FURTHER INFORMATION)
  - LAND NOT INCLUDED WITHIN THE ORDER LIMITS
  - SPECIAL CATEGORY LAND - OPEN SPACE - LAND TO BE ACQUIRED PERMANENTLY
  - SPECIAL CATEGORY LAND - OPEN SPACE - LAND TO BE ACQUIRED PERMANENTLY AND RETAINED FOR USE AS OPEN SPACE
  - SPECIAL CATEGORY LAND - OPEN SPACE - LAND TO BE USED TEMPORARILY AND RIGHTS TO BE ACQUIRED PERMANENTLY
  - SPECIAL CATEGORY LAND - OPEN SPACE - LAND TO BE USED TEMPORARILY
  - SPECIAL CATEGORY LAND - REPLACEMENT LAND
  - FULL DCO PLOT EXTENT

Post Acceptance Amendments	SM	JB	17/06/19	C02
First Issue	SM	CH	16/04/19	C01
Revision Details	By	Check	Date	Suffix

**DCO APPLICATION**

Client  
**Highways England**  
Floor 5  
Two Colonnade Square  
30 Colonnade Circus  
Birmingham  
B4 6BN

Development Consent Order Number  
**TR010022**

Project Title  
**A38  
DERBY JUNCTIONS**

Drawing Title  
**SPECIAL CATEGORY  
LAND PLANS  
REGULATION 5(2)(i)  
SHEET 10 OF 10**

Designed SM	Drawn LD	Checked CH	Approved SM	Date 17/06/19
----------------	-------------	---------------	----------------	------------------

Internal Project No.  
60533462

Suitability  
D7

Scale @ A1  
1:1250

Zone  
Whole Scheme

THIS DOCUMENT HAS BEEN PREPARED PURSUANT TO AND SUBJECT TO THE TERMS OF AECOM'S APPOINTMENT BY ITS CLIENT. AECOM ACCEPTS NO LIABILITY FOR ANY USE OF THIS DOCUMENT OTHER THAN BY ITS ORIGINAL CLIENT OR FOLLOWING AECOM'S EXPRESS AGREEMENT TO SUCH USE, AND ONLY FOR THE PURPOSES FOR WHICH IT WAS PREPARED AND PROVIDED.

Drawing Number HE514503	Originator -ACM	Volume -DCO	Rev C02
A38_SW_PR_ZZ	-DR-DC-9710		
Location	Type	Role	Number

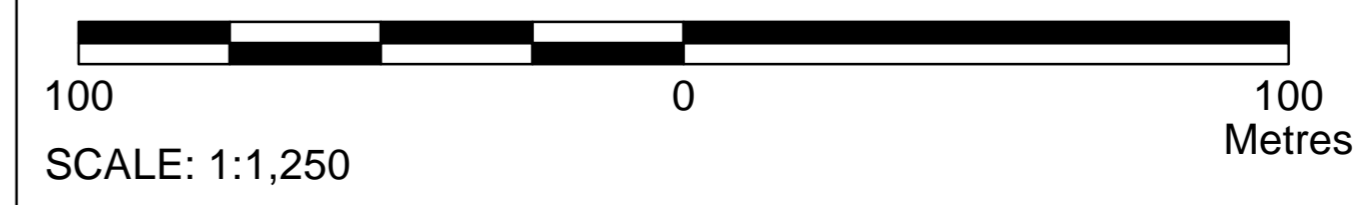

Plot Date: 18 June 2019 14:22:47  
File Name: G:\CAD\_IT\GIS COMMISSION DIRECTORY\A38 Derby - 302014 - Special Category Land Plans\HE514503-ACM-DCO-A38\_SW\_PR\_ZZ-DR-DC-9710.mxd

This map is based upon Ordnance Survey material with the permission of Ordnance Survey on behalf of the Controller of Her Majesty's Stationary Office © Crown copyright. Unauthorised reproduction infringes Crown copyright and may lead to prosecution or civil proceedings. Highways England 100030649 2019.